

SAVIN®

MP 401SPF

Multifunction B&W

- ✓ Copier
- ✓ Printer
- ✓ Facsimile
- ✓ Scanner



MP 401SPF

42 ppm
monochrome

Manage more types of tasks in less space

Your ideas may be big. But your office is not. So how can you carry out everyday document tasks — from copying, scanning, printing and faxing — and share your vision with others in such a small space? Place the compact, affordable SAVIN® MP 401SPF within arm's reach on the desktop, where you'll be able to create, access, protect and distribute documents in moments with the touch of a button. Use it as a standalone multifunction device for you or your workgroup. You can even incorporate it into an integrated Managed Document Services (MDS) strategy and help reduce printing costs throughout your organization.

Save time while saving space

When you're on deadline, you can't afford anything standing in your way, especially your printer. With the Savin MP 401SPF, you can produce up to 42 black-and-white pages per minute from a compact multifunction device to handle even large projects quickly. Copy, print, scan, fax and manage documents up to 8.5" x 14" at up to 1200 dpi for exceptional clarity that's sure to grab your customers' attention. You'll notice how much more work you can complete with a device that's small enough to fit on your desktop, and affordable enough to fit almost any budget.



Customize settings and work more quickly

Looking for new ways to work faster? It's right in front of you. Take advantage of a tiltable touch-panel display on the Savin MP 401SPF and create shortcuts for frequently used functions. Maybe you routinely send faxes to the same recipient, or scan documents directly to a specific email inbox — perform any task in moments with one-touch control from the Home Screen. You're in control of your information — wherever you are. Insert a USB memory stick or an SD card and print without a PC or a network connection. You can even use your smartphone or tablet to print without the need for additional software or drivers for fast output on the go.



Access critical information from anywhere

You're sharing information, not paper. Paper documents are slow to distribute and you have less control over who sees confidential information. Convert paper documents into electronic files and share them via network folders, servers and email directly from the device. Authorized users can access critical information quickly and without hassle. Administrators can check supply levels and configure settings on the Savin MP 401SPF in real time from a central location to simplify maintenance. Plus, you can integrate the MFP with the Integrated Cloud Environment (ICE) service for convenient Cloud-based services that eliminate technical costs for servers, system integration, software updates and on-site IT services.



Find the information you need. Now.

Productivity comes automatically

Work faster by letting the Savin MP 401SPF work for you. Take advantage of the embedded OCR option to insert invisible text or metadata on scanned images and simplify search and retrieval tasks. Use the ID Card Copy feature to scan two-sided documents (such as health insurance cards) on one side of a sheet of paper to reduce paper costs. Improve information distribution and collaboration by quickly scanning black-and-white or full-color originals. With Distributed Scan Management (DSM), administrators can create and assign scan processes and user rules centrally to simplify scanning for different groups of users.



Reduce operating and paper costs

Save money while saving the environment. Program the Savin MP 401SPF to power off automatically and reduce operating costs during downtimes. Take advantage of the new fusing unit that only powers up for copying and printing tasks to conserve even more energy. Cut paper use and costs in half with default duplex printing. Want to know if these features are working? Check the eco-friendly indicator for paper-saving metrics to encourage more sustainable printing. Plus, the device meets EPEAT® Silver criteria* — a global environmental rating system for electronic products — and is certified with the latest ENERGY STAR™ specifications.



Help keep your information secure

Protect users and your information with impressive security technologies. With the Savin MP 401SPF, you can apply user authentication requirements to monitor who is performing specific tasks. Restrict access only to authorized employees to keep information in the right hands. You can even restrict access to specific tasks with user authentication and force users to print with embedded copy protection to help secure printed data. Encryption for the hard drive helps to provide security for stored data. Plus, the DataOverwriteSecurity System (DOSS) can be added to destroy latent images on the hard drive.

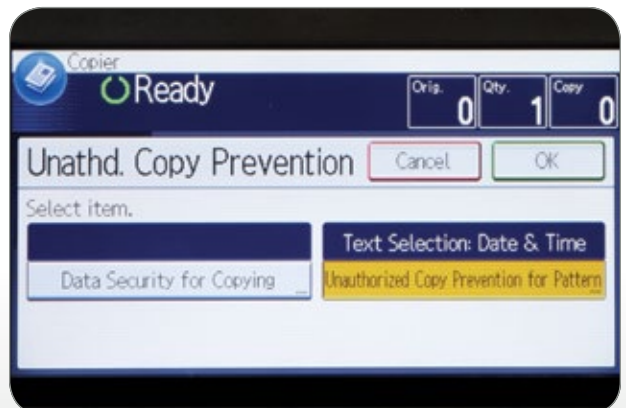

*EPEAT Silver rating is applicable only in the U.S.A.

Savin MP 401SPF

SYSTEM SPECIFICATIONS

Engine/General Specifications

Scanning Element	LED array
Printing Process	Dry, single component & electro-photographic printing
System Memory	1 GB (RAM) standard
Output Speed (Copy/Print)	Up to 42 ppm (Letter)
First Copy Time	6 seconds or less
Recovery Time to Product Ready Mode	Less than 14 seconds (from main power switch on) Less than 10 seconds (from sleep mode)
Copy Resolution	600 x 600 dpi (platen), 600 x 300 (ARDF)
Grayscale	256 levels
Exposure Adjustment	Manual and automatic
Multiple Copies	Up to 99
Document Feeder (Standard)	Automatic Reversing Document Feeder (ARDF)
Original Capacity	50 sheets (ARDF)
Paper Sizes	5.5" x 8.5" to 8.5" x 14" (A4/A5/A6/B5/B6/Legal/Letter/HLT/Executive/Folio) Trays Custom Size: 3.94" x 5.82" to 8.50" x 14.0" (100 x 148 mm to 216 x 356 mm) Bypass Custom Size: 2.37" x 5" to 8.5" x 35.43" (60 x 127 mm to 216 x 900 mm) 14 - 43 lb. Bond (52 - 162 g/m ²)
Paper Weights	Up to 8.5" x 14"
Exposure Glass	Standard: 500 sheets + 100-Sheet Bypass Tray Optional: 500 sheets x 1 or 2 Trays, 250 sheets x 1 or 2 trays
Input Capacity	Maximum capacity: 1,600 sheets 250 sheets (internal tray)
Output Capacity	Recycled, Colored, Letterhead, Preprinted, Plain Special, Thick, Thin, Bond, Cardstock, Prepunched, OHP (Transparency)*, Envelopes*, Label Stock*
Paper Types	Standard
Auto Duplex	25% to 400% in 1% increments
Zoom	65%, 78%, 93%, 100%, 129%, 155%
Preset Reduction and Enlargement Ratios	16.5" x 16.8" x 19.0" (419 x 427 x 484 mm) - includes ARDF
Dimensions (WxDxH)	49.5 lbs./ Less than 23 kg 120V, 60Hz Less than 1.180 kW (max) 0.59W 1.756 kWh/week***
Weight	ID Copy, Eco-Friendly Indicator, Auto Tray Switch, Document Server**, MFP Browser**, Image Rotation, Power On/Off Timer, Auto Start, Auto Off Timer, Combine Copy, Electronic Sort, Energy Saver Timer, Photo Mode, Series Copy, Margin Adjust, Cover/Slip Sheets, Job Programs (25), User Codes (8 digits, 1,000 Personal Codes), Unauthorized Copy Control
Power Requirements	*Bypass Tray only.
Power Consumption	**HDD option required.
Sleep Mode	***Typical Electricity Consumption by ENERGY STAR program.
TEC Value	
Standard Features	

Printer Specifications (Standard)

CPU	RM7035C - 533 MHz
Memory Capacity	Standard: 1 GB
Hard Disk Drive	Optional: 250 GB HDD
Page Description Languages	Standard: PCL5e/6, Genuine Adobe® PostScript®3*, XPS (available as an option)
Maximum Print Resolution	1200 x 1200 dpi
Standard Interfaces	Ethernet (RJ-45 network port: 10BASE-T/100BASE-TX/1000BASE-T), USB 2.0 Type A and B
Optional Interfaces	IEEE 1284, Wireless LAN (IEEE 802.11a/b/g/n)
Network Protocols	TCP/IP (IPv4, IPv6)
Fonts for PCL 5e/6	45 Roman fonts and 13 international fonts
Fonts for PS3	136 Roman fonts
Network Operating Systems	Windows XP/Server 2003/Vista/Server 2008/7/8/Server 2012; UNIX Filters for Sun Solaris 2.6/7/8/9/10; HP-UX 10.x/11.x/11iv2/11iv3; Red Hat Linux Enterprise V4, V5, V6; SCO OpenServer 5.0.6/5.0.7/6.0; IBM AIX Version 5.3, 6.1, 7.1; SAP R/3, 3.x or later, mySAP ERP2004 or later; Mac OS X 10.2 or later; Citrix Metaframe XP/ Presentation Server 4/5/ XenApp 5.0, 6.0
Utilities	Web SmartDeviceMonitor, Web Image Monitor, @Remote, Device Manager NX Media Direct Print (Print from USB/SD), Mobile Driver, Bonjour Support, Classification Code, Mail to Print*, PDF Direct Print, Sample/Hold/Store/Locked/Scheduled Print*, Store and Print*, Banner Page Print, Auto Job Promotion, Windows Active Directory Support, DDNS Support, WS Printer, PCL Resident Font Adoption, Tray-Parameter Change from WebImageMonitor, XPS Support
Other Printer Features	*HDD option required.
Scanner Specifications (Standard)	
Scanning Speed	32/30 ipm @ 300 dpi B/W (LT/A4) 21/20 ipm @ 300 dpi Full-Color (LT/A4)
Scanning Resolution	100 to 600 dpi
Scan Area	Main: 8.5" (216 mm) Sub Document Feeder/Platen: 23.6"/11.7" (600/297 mm)
Compression Method	B/W: MH (default), MR, MMR, JBIG2 Full-Color: JPEG
Scan Mode	B/W: Text, Text/Line Art, Text/Photo, Photo, Grayscale Full-Color: Text/Photo, Glossy Photo, Grayscale
Standard Interfaces	Ethernet 10BASE-T/100BASE-TX/1000BASE-T
Optional Interfaces	Wireless LAN (IEEE802.11 a/b/g/n)
File Formats	Single/Multi Page TIFF, Single/Multi Page PDF, Single/Multi Page High Compression PDF and Single/Multi Page PDF/A; Single Page JPEG
Scan Modes Supported	Scan-to-USB/SD, Scan-to-Email (POP, SMTP, TCP/IP); Scan-to-Folder (SMB/FTP/NCP); Scan-to-URL; Network TWAIN Scanning; WSD Scanner for Vista

Standard Features

Distributed Scan Management, PDF Encryption, Preview Before Transmission (TX Preview), Drop Out Color Send, Simultaneous Fax and Scan, Scan-to-PDF/A and Digitally Signed PDF, LDAP Support, TWAIN Scanning
*HDD option required.
*Network option required.

Fax Specifications (Standard)

Type	G3
Circuit	PSTN, PBX
Resolution	200 x 100 dpi, 200 x 200 dpi
Modem Speed	33.6K - 2,400 bps with Auto Fallback
Compression Method	MH, MR, MMR, JBIG
Scan Speed	Up to 22 SPM (Letter/A4)
Transmission Speed	Approx. 2 seconds/page (JBIG)
Memory	4 MB (approx. 320 pages)
Memory Backup	12 hours
Quick/Speed Dials	1,000 (2,000 with HDD Option)
Group Dials	100 groups
User Function Key	3 keys
Standard Features	Detection of Misplaced Documents, Double Check Destination Address, Direct SMTP, Simultaneous Fax and Scan, Fax Forward to Email/Folder, Internet Fax (T.37), IP Fax (T.38), LAN Fax, Paperless Fax*, LDAP Support, Document Server Stored Data Sending*

*HDD option required.

Paper Feed Unit PB1060 (Option)

Paper Size	5.5" x 8.5" SEF, 8.5" x 14" SEF (A4/LT/HLT/LG)
Paper Weight	14 - 43 lb. Bond (52 - 162 g/m ²)
Paper Capacity	250 sheets x 1 or 2 Trays

Paper Feed Unit PB1070 (Option)

Paper Size	5.5" x 8.5" SEF, 8.5" x 14" SEF (A4/LT/HLT/LG)
Paper Weight	14 - 43 lb. Bond (52 - 162 g/m ²)
Paper Capacity	500 sheets x 1 or 2 Trays

Additional Accessory Options

Memory Unit Type M 1 (1.5 GB), HDD Option Type M6 (includes HDD overwrite and encryption), OCR Option Type M2, Adjustable Height Cabinet Type G, IEEE1284 Interface Board Type A, IEEE802.11 Interface Unit Type O, VM Card Type W, File Format Converter Type E, Browser Unit Type M6, Optional Counter Interface Unit Type A, Copy Data Security Unit Type G, XPS Direct Print Option Type M6

Security Features (Standard)

Unauthorized Copy Control; Quota Setting/Account Limit; SMTP over SSL; Hard Disk Drive Data Overwrite Security; Authentication (Windows/LDAP/Kerberos/Basic/User Code/802.1x Wired); Encryption (Address Book/Authentication Password/SSL Communication/S/MIME/IPSec/HDD); Network Protocol (Port) On/Off; IP Filtering; Copy Data Security Unit Type G (Option); RAM Based Security when HDD is not installed

*Only required with HDD option.

Some features may require additional options.

MP 401SPF Adjustable Height Cabinet Configurations



Standard
500 Sheet
Tray



Standard
Tray with
one 500
Sheet Tray



Standard
Tray with
two 500
Sheet Trays



Standard
Tray with
one 250 and
one 500
Sheet Tray

www.savin.com

Ricoh Americas Corporation, 70 Valley Stream Parkway, Malvern, PA 19355, 1-877-472-8466
Savin® and the Savin logo are registered trademarks of Ricoh Americas Corporation. Ricoh® and the Ricoh Logo are registered trademarks of Ricoh Company Ltd. All other trademarks are the property of their respective owners. ©2015 Ricoh Americas Corporation. All rights reserved. Savin products and services are offered by Ricoh Americas Corporation and its affiliates. The content of this document, and the appearance, features and specifications of Savin products and services are subject to change from time to time without notice. Products are shown with optional features. While care has been taken to ensure the accuracy of this information, Ricoh makes no representation or warranties about the accuracy, completeness or adequacy of the information contained herein, and shall not be liable for any errors or omissions in these materials. Actual results will vary depending upon use of the products and services, and the conditions and factors affecting performance. The only warranties for Savin products and services are as set forth in the express warranty statements accompanying them.

S3522

